

Owners Manual and Service booklet

UP Profile light



PROFILE *light*



Version 3.0
Valid from 2006
Stand: November 2007

The data and statements contained within this manual may be changed without prior notice. No part of these documents may be copied or transmitted for any purpose in any manner or by any means, either electronic or mechanical, without explicit written permission from Ultralite Products International.

Table of contents

WELCOME IN OUR TEAM	8
SAFETY INSTRUCTIONS	9
TECHNICAL DESCRIPTION	9
GENERAL	9
TECHNICAL DATA UP PROFILE LIGHT	10
OVERVIEW	11
EQUIPMENT CONFIGURATION	11
EQUIPMENT CONFIGURATION	12
<i>Canopy, Lines and Bridle</i>	12
<i>The Inner Container</i>	12
<i>The Outer Container</i>	12
NECESSARY DOCUMENTATION	13
USAGE	13
MAXIMUM DEPLOYMENT VELOCITY	13
USING THE RESERVE PARACHUTE	13
CHECKING THE PARACHUTE SYSTEM	14
PACKING THE RESERVE CANOPY	15
LAY OUT AND ARRANGE	15
FLAKING THE CANOPY	16
PACKING THE CANOPY IN THE INNER CONTAINER	20
CLOSING THE OUTER CONTAINER	20
CLOSING THE OUTER CONTAINER	21
<i>Harnesses with built-in reserve</i>	22
THE PACKING CARD	22
INSTALLING THE UP PROFILE LIGHT IN A HARNESS	23
MOUNTING THE UP PROFILE LIGHT OUTER CONTAINER ON YOUR HARNESS	23
TOWING WITH THE UP PROFILE LIGHT	24
INSTALLING THE UP PROFILE LIGHT IN A HARNESS WITH INTEGRATED RESERVE CONTAINER	24
SAFETY RUPTURE THREAD	25
DEPLOYMENT	25
COMPATIBILITY	26
FURTHER TIPS	26

<i>Transport</i>	26
<i>Storage</i>	26
<i>Salt water</i>	26
<i>Water, Sea water</i>	26
<i>Insects</i>	26
<i>Environmentally responsible disposal</i>	27
<i>Environmentally responsible behaviour</i>	27
MAINTENANCE AND CLEANING	28
TAKING CARE OF YOUR RESCUE SYSTEM.....	28
CLEANING	28
CHECKS AND REPAIRS	30
MAINTENANCE	30
<i>Working life limits</i>	30
<i>Airworthiness Check</i>	30
<i>Packing intervals</i>	30
<i>UP Craftsmanship</i>	30
<i>Replacement parts – only by UP!</i>	30
UP WARRANTY.....	31
<i>National warranty conditions</i>	31
<i>International UP warranty</i>	31
SENDING THE UP PROFILE LIGHT AND OTHER UP PRODUCTS	32
UP HOMEPAGE	32
 ATTACHMENTS	
Luftsportgeräte-Kennblatt UP Profile light	34
 Service Booklet	
Rescue system and pilot data	36
Service verification stamps	38
Emergency parachute logbook	40
Product registration card	41

Important

The following symbols are used to draw attention to particular sections:

**WARNING!**

Failing to comply with instructions given here may lead to injury or death!

**BEWARE!**

Failing to comply with instructions given here may cause undue wear to, or even damage, your new equipment.

**NOTICE**

This pictogram indicates a tip or some helpful extra knowledge.

Welcome in our team

Congratulations on the purchase of your new UP Profile light rescue system. Although we hope you'll never need it, we assure you that with the UP Profile light you have chosen a rescue system that represents the maximum in safety, functionality and quality in our sport. In order to ensure that you get the maximum passive safety out of your reserve parachute we recommend that you take a little time to read this manual and thus become familiar with the functioning, the maintenance and the packing intervals.

Please take a little time to complete and send the reply card (product registration) found in the back of this manual, or by doing the same Online via:

www.up-paragliders.com > service > product registration

Your completed product registration is also needed should any warranty issues arise. After a successful product registration we can keep you informed of all new products and developments at UP, as well as any technical information about the UP Profile light.

We would also be delighted to hear any feedback you have concerning the rescue system. It is only through your feedback that we can continue to develop world-class paragliding equipment that appeal to the majority of pilots.

If you have any questions regarding your rescue system or auxiliary equipment please ask your local dealer or feel free to contact us here at UP directly.

Your UP International Team

Safety instructions



Paragliding is an extremely demanding sport requiring the highest levels of attention, judgment, maturity, and self-discipline. Due to the inherent risks in flying this or any paraglider, no warranty of any kind can be made against accidents, injury, equipment failure, and/or death. This rescue system is not covered by product liability insurance. Do not use it unless you are personally willing to assume all risks inherent in the sport of paragliding and all responsibility for any property damage, injury, or death, which may result from use of this paraglider rescue system.

Please read this owner's manual thoroughly before your first flight with the UP Profile light so that you are fully acquainted with your new rescue system. This manual gives you information on the entire specific and general characteristics of the UP Profile light. It is important to note the following points:

- At the time of delivery the UP Profile light conforms to the EN 12491 / LTF 35/03 requirements, tested by European Academy of Parachute Rigging e.V. (EAPR).
- Any changes being made outside the permitted range of adjustment invalidate any and all claims under the warranty.
- Using this rescue system is exclusively at the risk of the user; the manufacturer or distributor assumes no responsibility for accidents occurring while using it.
- The pilot assumes total responsibility for the use of the rescue system. Before each flight the pilot must

perform a mandatory check of the condition of the rescue system.

- It is assumed that the pilot is in possession of the necessary qualifications and that provisions of any relevant laws are observed.
- When reselling the rescue system please make sure you also give this manual to the new owner. The manual is an integrated part of the paraglider and is required for the wing to keep its certification.

Technical description

General

The UP Profile light is a modern, extremely light rescue parachute for use with paragliders.

Highlights of the UP Profile light

- Paragliding Rescue with Pull Down Apex Design
- Air outlets give faster opening times and a certain amount of steering
- Central line
- Easy to pack and minimal packing volume
- Special cylinder container that doubles as instrument cockpit
- Two bridle straps used for attaching to the main harness hang points
- Long-lived, strong materials
- Fulfills test standard EN 12491 / LTF 35/03

Technical Data UP Profile light

Type	Profile light
Area	24,00 m ²
Projected area	12,56 m ²
Projected diameter	4,00 m
Projected circumference	12,56 m
Suspension line length	4,00 m
Center line length	4,30 m
Number of panels (parts)	16 - (32)
Number of suspension lines	16
Number of centre lines	2
Max. flight weight*	100 kg
Min. flight weight	40 kg
Recommended flight weight	90 kg
Sink rate with 90 kg weight**	5,5 m/s
Opening speed**	4 s
Stability**	Less then 10° of swaying from the vertical axis
Dimension packet	280x90x90 mm
Total weight (without outer container)	1,6 kg
Test Standard	EN 12491 / LTF 35/03
Test Reference No.	EAPR-RG-7000/07
Description	Paragliding Rescue (Pull Down Apex Design)

Overview

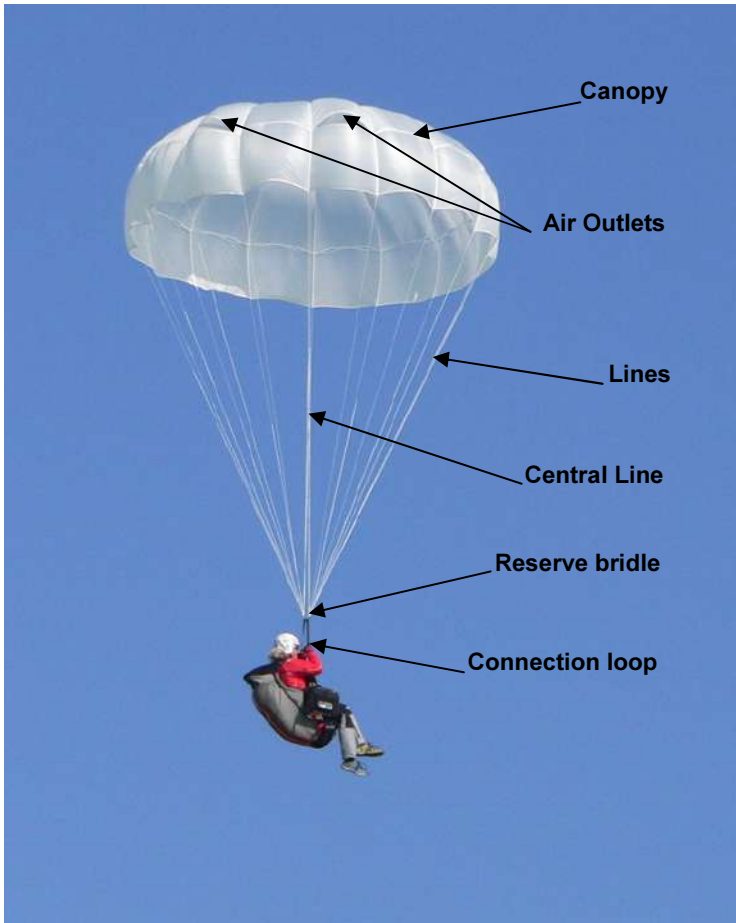

PROFILE *light*

Equipment configuration

Canopy, Lines and Bridle

The most important part of a rescue system is its canopy. The UP Profile light is designed as a proportionally shaped canopy with central line and double air-filling to optimize the relation between the amount of used material and projected area. The canopy is constructed from 32 panels.

What is double air-filling or double cell construction and what is it used for? Basically it shortens the opening time of the rescue. After complete opening of the UP Profile light, the filling openings remain partially open and air flows through them against the movement of the rescue which results in lower sink rate and greater stability.

The material used for the UP Profile light has a great affect on opening and flying characteristics. The UP Profile light is made from the French fabric Porcher Marine 90 82.

Other important parts of the UP Profile light are the lines. There are 16 main and two central lines. Their main characteristics are strength, ability to stretch and absorb part of the opening shock.

- Breaking strength of main lines: 220 daN
- Breaking strength of central lines: 370 daN
- Elasticity of lines: 33%
- Bridle's breaking strength: > 2000 daN.

The Inner Container

Inner container is made from light but durable materials. It is connected to the

handle by two 6 centimetre long straps, so after pulling out from outer container we have a compact packet which can be easily and accurately thrown away with sufficient force.

For safety and functional reasons the loops for attaching the lines are on the outside of the container, so the container remains closed for at least 1.5 meter after deployment. One reason to keep it closed is to prevent immediate deliberate opening right after pulling out from outer container. Second - the rescue starts to open in safe distance from the pilots' aerodynamic wake (rescues opening in a wake can cause delayed inflating or sticking of rescue to pilot's body).

The Outer Container

The outer container is made from a very durable waterproof ballistic cloth. It is designed for use with majority of modern harnesses and the special shaped cylinder container doubles also as instrument cockpit.

The outer container has a snaplock fixation to allow attachment to the chest strap of the harness. The two lateral connection loops are clicked into the main karabiners of the harness.



WARNING! Always attach both bridles to the harness via the two lateral connection loops. Severe potential malfunction will result if you fail to do so; indeed it will render the UP Profile Light useless.

Necessary documentation

The following papers are an integrated part of the UP Profile light reserve parachute, and must follow each canopy throughout its working life:

- The manual
- The packing-card

Usage

The UP Profile light series are manually deployed reserve parachutes for paraglider pilots to use in emergencies.

The UP Profile light has been specially developed and tested as a second rescue for test-, acro-, cross country and competition pilots. Beside this the UP Profile light is an alternative for mountaineering paragliding pilots who have previously, in order to save weight, been flying without a reserve.

UP International does not recommend using the UP Profile light as main reserve for normal flying. In this case we recommend our professional UP Profile series that have bigger surface areas and better sink rates.

The UP Profile light was not designed or tested for use in skydiving or base jumping, and must be used with [certified] paragliding harnesses only.



WARNING! Any other usage is dangerous and will invalidate all warranty claims. These free-flight emergency parachutes are NOT designed for jumping out of airplanes!

Maximum deployment velocity

According to the EN 12491 the UP Profile light should not be used above speeds of 32m/s or 115km/h.

Using the reserve parachute

It's recommended to try a practice deployment before your first flight, so you can familiarise yourself with the proper function of the outer container and the UP Profile light in general.

If you find yourself in an uncontrollable situation in the air pull hard on the deployment handle. This will open the outer reserve container and release the reserve parachute. If the UP Profile light is in its original front mount container it is possible to throw it to either side with either hand



NOTICE! For a fast opening it's important to throw the reserve package forcefully away from you into free open space. It is necessary to throw away the container with as much force as possible to shorten the opening time. If your glider is spiraling / rotating it pays to throw the reserve against the rotation as this will speed up the inflating process. If you have had a collision and find yourself entangled with someone else's glider try to make sure you don't throw the canopy into the entanglement, as this will delay the opening.

The air current stretches the lines and peels away the inner container. This releases the actual canopy and lets it

open. Once fully open most authorities suggest pulling in or B-lining the paraglider to avoid having the two canopies working against each other while descending in a wide V.

We recommend that you practise this procedure under qualified instruction in a gym (such arrangements are offered by most schools and clubs around the world) and that you have your harness/parachute configuration tested by qualified professionals before flying. It is also a good idea to go through the entire deployment procedure before each flight to ensure that you are mentally prepared in the event that you suddenly need to use your UP Profile Light reserve parachute.

place. This thread must have a maximum breaking load of 20N. Further to this subject in the "Safety rupture thread" chapter.

Checking the parachute system

Before packing the UP Profile light it must be checked by a certified parachute rigger. In case the parachute has been deployed in earnest it must be sent to the manufacturer or to a manufacturer-approved checking facility for a complete check-up. Whenever re-packing an already packed parachute make sure that it remains deployable after installing it in the paragliding harness. This procedure is called the Compatibility Test and must be performed each time the parachute is installed in a harness.

One of the things that must be verified is that the force needed to deploy does not exceed 70N, which is the equivalent of what the certification authorities consider a suitable one-handed deployment force. Thus, if the deployment force is 70N or less the parachute is approved.

To avoid accidental deployment the certification body accepts the use of a thin piece of cotton thread holding the pin in

Packing the Reserve Canopy

Lay out and arrange

The UP Profile light, and indeed all parachutes, should be opened and aired for at least a day before re-packing. This eliminates any humidity present in the fabric. The packing operation is best done on a rigging table or at least on a clean flat surface.

The parachute is stretched out on the packing surface. Insert a temporary line in the tabs at the vertex of the chute through the sewn-in tabs (Picture 1A). Attach the bridle to the other end of the table, stretching out the canopy tight between the temporary line and the bridle (Picture 1B).



Picture 1A

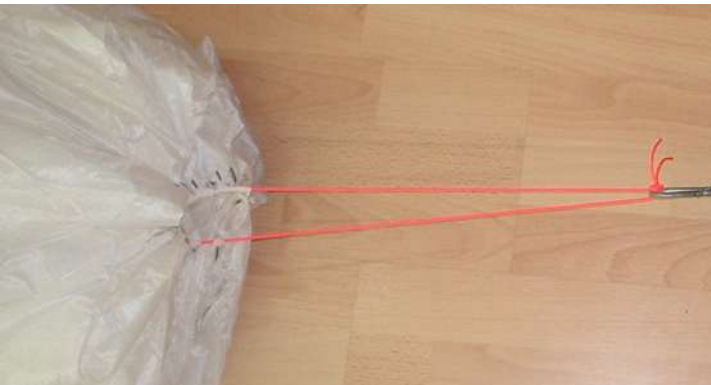

Picture 1B



In order to maintain an even pull on the entire parachute with lines we suggest you suspend a weight (your harness or a sand bag) off the bridle hanging over the edge of the table.

The lines are to be inspected for damage and to ensure that they are straight. To accomplish this, take any two adjacent lines, for example, Pos. 1 and 16, and walk them down to the bridle, checking for any cross-tangles. If there are any tangles, continue this process, looping the bridle through the crossed line at the juncture of the lines and the bridle until all tangles have been removed.

Flaking the Canopy

Divide canopy gores evenly into right and left side (8 by 8 gores). Reserve canopy gores are not symmetrical and they are all numbered. Always start folding with right hand side, on the bottom - gore #8 and finish the side with gore #1 on the top (Pictures 2).



Pictures 2

Folding of left side starts with gore #9 and finish with gore #18 (Pictures 3).



Pictures 3



Loose the tension on bridles' side. Separate the lines equally into right and left halves to prevent any tangles. Tension up the bridles again and check for any line crossings or entanglements (Picture 4).



Picture 4



Picture 5



WARNING! Now is the time to remove the packing line threaded through the packing loops at the vertex of the canopy (Picture 5). Failing to do so will render the parachute dysfunctional! Failing to follow this procedure may render your emergency parachute unusable!

Both halves fold longitudinally into thirds: make first 1/3 fold under rescue and second one on the top of rescue (Pictures 6). Folding the rescue into thirds to make a Z shape - one third on top and the other below - improves opening speed and symmetry.



Pictures 6

Straighten out all wrinkles on the rescue (which is folded into thirds), press out air and start folding (Pictures 7 and Drawing step – 1).



Pictures 7



Another fold is done around and on top of the first one (Drawing steps 2 & 3) and continue after that with 'Z' folding upwards (Picture 8).

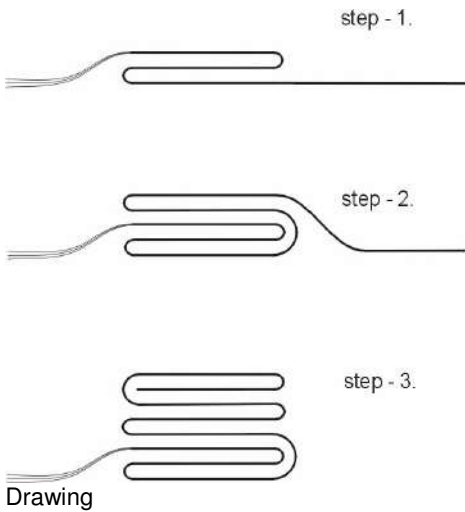

Picture 8

Packing the canopy in the inner container

Once again make sure you have removed the packing line from the tabs at the vertex of the canopy. If this line is not removed, the parachute will not open!

Insert the folded canopy into the inner container and fold up lines into 'figure8' loops and secure them with rubber bands on inner side of container until you reach approx. 180 cm from bridles. Close the container with rubber loops and secure them with approx. 3-4 centimetre loops made from lines. Force needed to open container (slip the loops of lines out of rubber loops) should be in range of 300-900 g. The rest of lines, approx. 120 cm, folds up into 'figure8' loops and are secured with rubber bands on the outside of the container.

Take care to keep the lines well sorted, with each line matching the others in the length of the loop passed through the rubber bands.

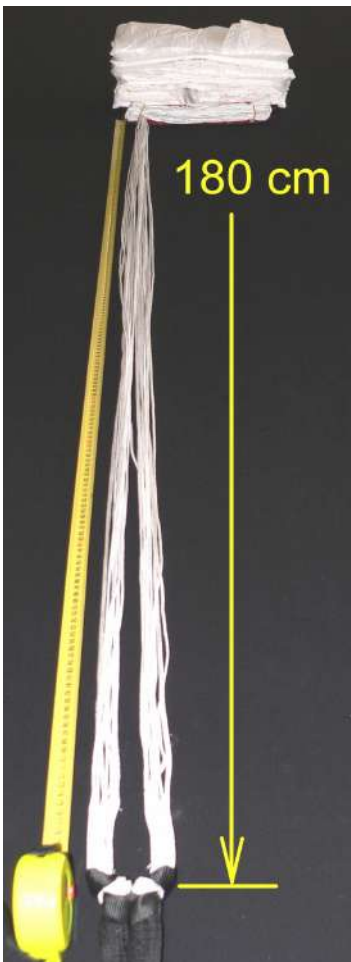

Pictures 9

Closing the outer container

To start closing the outer container, take bridles and attach them to Velcro on inner side (Bridles' span should be similar to width of harness chest strap plus approximate 7 centimeters). Then close container and secure it with the two plastic pins from the deployment handle. Folding of rescue and closing of outer container have to be done carefully and slowly so that the rescue fits easily into outer container. Check the function of outer container. Attach rescue to harness, and make practice deployment in flying position. Force needed to pull out rescue should not exceed 10 kg.





Pictures 10

Harnesses with built-in reserve

When installing the UP Profile light in the harness, please follow the instructions delivered with your harness. This is also the place to look for information regarding the closing of the outer container. Further info to this topic in the “Installing the reserve in a harness” chapter.

The Packing Card

Each pack should contain a current inspection card recording the date, name, and signature of the packer/checker as well as the location of the approved inspection site.

Installing the UP Profile light in a harness

The UP Profile light can be used in conjunction with most approved harnesses on the market, but UP International cannot guarantee that it will function perfectly with every available harness.



WARNING! Always make sure that you perform a compatibility test harness/reserve when you have installed your reserve in the harness. This is done by hanging the harness

in a flying position, buckling up and then deploying the reserve. If there is **ANY PROBLEM** the harness/reserve combination may be dangerous to fly! Should you still have doubts or questions we suggest that you contact your UP dealer or UP directly.

Mounting the UP Profile light outer container on your harness

If you use the UP Profile light as second rescue (or if you fly a mountaineering harness without a built-in reserve container) you can mount the UP Profile light in its outer container on the harness.

Put your harness on in the usual manner, close carefully all buckles and adjust your harness like you would for any other flight. Then connect first one, then the other side of the UP

Profile Light to your harness, as shown in Illustration 11, in the red circle.



Illustration 11

Once this is done we suggest you close the Velcro or the plastic click buckle (depending on your version) around the chest strap of the harness.

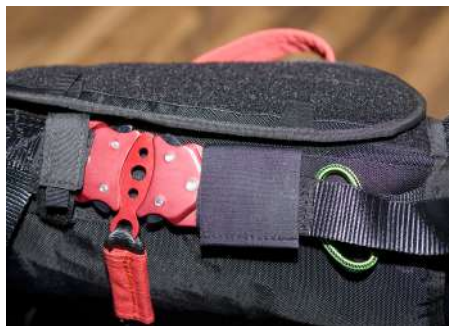

Illustration. 12

Make sure that all connections are secure and that the karabiners have been properly closed and locked. Verify that no moving parts (the speed bar line or any movable parts of the harness construction) are hindered in

their movements by the UP Profile Light.



Illustration 13

It is the responsibility of the owner/user to ensure that none of the Stepps carried out above are in conflict with the harness user manual. Once the UP Profile Light has been hooked into the harness you may connect the paraglider risers as per normal.

Checklist:

- Verify that all buckles and straps are safely secured. The best way to do this is by starting with the lowest ones and working oneself up, grabbing hold of each and every one in the process.
- Connect the parachute's right bridle into the right karabiner
- Connect the left bridle to the left karabiner.
- Attach the parachute container to the chest strap using the Velcro/plastic click buckle (depending on version)

- Verify that the closing pins are securely in place before launching. An accidental parachute deployment may have dangerous consequences.

Towing with the UP Profile Light

Always adhere to the harness and glider manufacturer instructions. Ensure that the distance between the karabiners is not reduced due to the use of the UP Profile Light – reduced karabiner distance increases the risk of riser twists.



BEWARE! If you are using the UP Profile Light with the original chest-mounted outer container you must always verify that the tow-line release

mechanism does not impede proper deployment of the parachute at all times. We recommend using a Y-shaped strap tow release.

Installing the UP Profile light in a harness with integrated reserve container

When installing the UP Profile light in a harness please follow the user manual delivered with the harness. The following directions must however always be adhered to:

- Use only the original deployment handle delivered with the harness. Using other handles will compromise your safety

- If your inner container has an asymmetrically located attachment loop for the deployment handle make sure that you turn the inner container in such a way that the attachment loop is orientated towards the direction of the deployment pull. Failing to do so may render your parachute un-deployable
- Also make sure that the connection between handle and pin is shorter than between handle and inner container. If the opposite is the case you may find yourself pulling on the container when attempting to deploy, without releasing the pin
- Attach the deployment handle in such a way that the connection band is not fully stretched out – this could result in involuntary deployment because the pin could get pulled out
- After each repack the whole system must be tested and tried; see “Compatibility check” above!

If you are in any way insecure about the installing of your reserve parachute please leave it to trained professionals to do. Mounting a reserve parachute wrongly may severely compromise your safety in the event of a glider mishap.

Safety rupture thread

In order to eliminate the risk of accidental deployments the German air sports authorities stipulate a minimum deployment force of 20N to extract the pins. If your parachute does not reach this value a safety rupture thread must be installed. The purpose of the thread is to ensure a minimum deployment force of 20N. The thread is

threaded through the eye of the closing pin and the closing loop and secured with a knot and an anti-tamper seal (see illustration).



The following materials are recommended for use as safety rupture threads:

Seals for emergency parachutes
NSN: 8310-01-493-6030
4 Cord Cotton –Intrinsic 24
Breaking load: 4,70 to 4,75 lbs – 21



WARNING! The thread, locking pin and the proper installation of the inner container should be checked before each flight. Use only suitable thread – it must not be too strong!

Deployment

When pulling the deployment handle the first thing to give is the cotton thread. Then the locking pin is pulled out and the outer container opens. The deployment handle is attached to the inner container through the connection strap and allows the pilot to forcefully throw the reserve in the desired direction, away from the main canopy.

When installing the reserve system make sure that the deployment sequence is as described here. Any other sequence means danger!

Compatibility

The installation of the integrated reserve container and the installation of a reserve parachute therein should be approved by the manufacturer of the harness or reserve parachute. This to ensure that the configuration works properly and that all installations have been carried out correctly.



BEWARE! After each packing a test release should be done in order to guarantee the normal function of the emergency parachute. The deployment of the emergency parachute must be feasible from each possible flight position.

Be sure to fully deploy the inner container so that you can verify that it comes out all right.

Further tips

The changing of any aspect of the UP Profile light invalidates any and all warranty claims.

Transport

Make sure that you do not expose your UP Profile Light to extreme temperatures, like they may occur in a car parked in the sun. Always treat your parachute like something that may one day save your life, don't load heavy goods on top of it, don't pile it in with a lot of potentially soiling agents, don't allow sharp object near it etc. When loading the equipment into the glider backpack make sure there is no

risk of mechanical abrasion against metal parts, and verify that the pin cannot accidentally be extracted.

Storage

Always store your UP Profile Light in a dry, well ventilated place. It should be stored out of direct sunlight, and there should be no chemicals or solvents stored near by. The temperature should be stable between 10 and 25 degrees Celsius, and the relative humidity should be between 50 and 75%.

Salt water

Flying with the UP Profile light mounted in the harness in very humid/salty environments may accelerate the ageing process. If your flying environment is extraordinarily aggressive make sure you have your reserve repacked and checked more often than the normal check interval.

Water, Sea water

Should your UP Profile Light become damp or wet it should be dried immediately in a well-ventilated space (not in direct sunlight. If it is stored away wet or damp the cloth, lines and all other materials will age prematurely. Furthermore the correct and quick deployment cannot be guaranteed with a wet or damp parachute!

If the parachute has been sprinkled or submerged in sea water it must be rinsed thoroughly and dried as above as soon as possible.

Insects

Never pack insects into the canopy when repacking it. Many insects

contain acids that may damage the canopy if left unattended. .

Grasshoppers may try to gnaw their way out, making holes in the cloth while they are at it. Besides, grasshoppers exude a dark colorant that will stain your canopy.

Environmentally responsible disposal

Once your UP Profile Light has reached the end of its service life it is important to ensure that it is disposed of in an environmentally responsible manner. We recommend you return the parachute to UP International, and we will make sure it is disposed of properly.

Environmentally responsible behaviour

To round this off just a few brief words about practising our sport in a way that protects and respects the environment. Never walk outside the marked trails, never leave anything behind, make no unnecessary noise and do respect the biologic balance of the mountains. The launch is an area where particular care must be taken to avoid negative impact on the environment.

Maintenance and cleaning

Taking care of your rescue system

The „UP Profile Light was developed with particular focus on weight and volume. The materials used in the manufacturing were chosen accordingly.

The actual service time that you will get out of your new rescue system depends to a high degree on the way you treat it! Always beware that the condition of your rescue system is closely linked to your own personal safety. Check it frequently for signs of wear and have damaged components replaced immediately by UP authorised repair facilities.

Take special care to check all structural stitching. Any damaged stitching must be repaired immediately by a UP authorised repair facility.

Furthermore you are always welcome to send your harness to UP Europe for checks and repairs!

To avoid unnecessary weakening of the UP Profile light rescue system we recommend the following precautions:

- Should the parachute get wet it must be opened, dried out (never in direct sunlight!) and repacked. A wet, or even just a humid reserve parachute may not function properly and may become mildewy. If the damp canopy is subjected to even moderate heating the cloth may begin to disintegrate.
- Should your parachute be exposed to excessive mechanical abrasion it must be returned to UP

for checking. One example could be the harness with the reserve mounted being run over by a car. If in doubt always return your parachute to UP for professional checking.

- Avoid fire and sharp objects near the rescue system
- Avoid unnecessary UV exposure (sunlight). UV radiation affects the molecular structure of the materials used for the rescue system and will weaken it if exposed for longer periods
- Avoid exposure to salt water or acids. Should the parachute become exposed to salt water it must be rinsed with fresh water, dried and repacked
- If you find yourself hanging under your parachute from a tree, check it very carefully for wood resin. Resin may impede future opening of the parachute
- UP recommends repacking the parachute every 6 months

Cleaning

If you feel it necessary to clean your UP Profile light at any time then use lots of lukewarm water and a soft sponge. More stubborn stains can be cleaned with a weak soap solution, and rinsed thoroughly. Subsequently dry out the canopy in the shade or in a well-ventilated room.



BEWARE! Never use chemical cleaning agents, brushes or hard sponges on the material, as these destroy the coating and affect the strength of the cloth.

Never attempt to clean your parachute in a washing machine. Even without using detergents the simple mechanical abrasion will quickly finish the canopy and render it useless. Also avoid dipping it in a swimming pool; the chlorine will damage the cloth. If you **MUST** rinse the parachute, for example following a sea water landing, do so with a gentle spray with fresh water. Frequent spraying will accelerate the ageing process.

Checks and repairs



Paragliding is a wonderful sport; flying as free as a bird in the air, enjoying the peace and tranquility. But the air is an alien environment that commands respect and a responsible attitude from the pilot.

At UP we don't just put our knowledge and experience into the development of paragliders, but also into their maintenance, service and repairs to ensure that you can fly safely at all times.

Repairs or inspections must only be carried out by UP International or a UP approved repair/checking facility.

Maintenance



BEWARE! All maintenance must be carried out in accordance with UP recommendations. To ensure that this happens we strongly advise you to only let UP recognised service

centers touch your wing – this is also a prerequisite for the UP Warranty to be valid. So there's a lot speaking for letting UP, or a UP affiliate, look after your Profile light!

Working life limits

The UP Profile light has the following limits to its working life:

- 10 years when the inspections follow a 2-year cycle
- Thereafter another two years, with inspections once every year

Airworthiness Check

The UP Profile light must be checked for airworthiness at the following intervals:

- 2 years after purchase
- Every two years after that, or sooner if prescribed by the UP checking facility during the last check

We will happily service the glider more often, if you feel that it is necessary.

Packing intervals

Please note that regular repacking of the UP Profile light is essential for it to function 100%!

- The UP Profile light must be repacked every 6 months.

UP Craftsmanship

In order to ensure that your UP Profile light maintains its very high inherent performance and safety we highly recommend that you employ UP, or a UP affiliate, with any repairs or maintenance. Our service staff is trained and skilled, and knows the UP wings better than anyone.

Replacement parts – only by UP!

The UP Profile Light consists of a large number of premium parts with excellent life expectancy. When replacing parts (lines, bridles, cloth etc.) **ONLY** original parts may be used. This is not only a prerequisite for conserving the certification, it is also important for your safety!



- 1 Outer container
- 2 Flight deck (for instruments)
- 3 Deployment handle with inner container
- 4 Bridles (x2)
- 5 Main lines (x16)
Centre lines (x2)
- 6 Packing elastic bands
- 7 Owners manual

UP Warranty

Conditions and extent of the UP International Warranty can be found in the following pages. For further information please ask UP International directly, or you local representative. The UP importer in your country is always delighted to clear any questions with you.

National warranty conditions

In some countries the local laws stipulate different warranty rules than those outlined here. Please note that these local rules only apply in the country where you have purchased your wing. Information about local

rules and conditions are available from your local dealer.

International UP warranty

Warranty conditions:

The international UP warranty covers material- and workmanship faults and is valid for 24 months from the delivery date. It can be extended for a further 12 months by letting UP do all service and maintenance, including the two-years compulsory check. Outside of Germany and Austria UP-approved service centers may perform these checks.

The UP warranty covers the cost of materials and workmanship on gliders accepted by UP to fall under the warranty. The UP warranty does not cover damage caused by accidents, or by changes made to the glider. Likewise, parts that are damaged due to normal wear and tear are exempt from warranty coverage. Fabric colour changes that do not influence the behaviour or safety of the wing are not covered by the warranty, and neither are faults caused by the exposure to solvents or salt water, or plain incorrect handling of the wing.

For any warranty claim to be accepted the following conditions must be adhered to:

- The rescue system was used under normal circumstances and was maintained according to the instructions given by UP International. Note that these include instruction for the correct packing, storing and cleaning
- The rescue system was only used in accordance with its DHV certification
- Only original UP spares have been used, and only UP, or a UP

affiliate service centre, has performed repairs or service jobs on the paraglider

- A complete, correct registration card has been filled in and sent to UP within 14 days of the purchase. Note that you may also register your rescue system via the UP homepage www.up-paragliders.com>service>UP Product registration

UP reserves the right to refuse any claims not honouring one or several of these conditions. However, in some cases an “ex gratia” settlement may be offered.

Sending the UP Profile light and other UP products

The best way to send your paraglider, rescue parachute, harness etc. to our service team is in a stable box via post or UPS. Enclose a note of what requires doing (2 Year Check, repair, repack etc.) and also your daytime contact details. We will return your equipment either by post or UPS. Please indicate preferred method of payment (either bank cheque or C o d)/

Should you require any further information about the services we offer, please contact us at the address and phone number below. We are also able to give you information about your nearest Authorised Service Centre, as well as other manufacturers who are authorised to check and repair UP gliders and equipment.

UP International GmbH
-Abteilung Service-
Kreuzeckbahnstrasse 7

D-82467 Garmisch-Partenkirchen

Email: service@up-paragliders.com

Service Fon: +49 (0) 88 21-73099-0

Fax: +49 (0) 88 21-73099-16

UP Homepage

The UP Homepage gives you information about the latest news and products from UP. You will find any technical information and accessories for your UP Profile light, as well as many useful things that are necessary for flying.

Beside paragliders, harnesses and flying equipment you will also find the new “Skywear” collection with the latest flying garments and the “News” section, which will keep you updated with all activities around UP.

www.up-paragliders.com

Attachments

Luftsportgeräte-Kennblatt UP Profile light 34

Service Booklet

Rescue system and pilot data 36

Service verification stamps..... 38

Emergency parachute logbook..... 40

Product registration card 41

Herstellerangaben zum Luftsportgeräte-Kennblatt

Gleitsegel-Rettungsgerät (RG)

I. Musterprüfung

1. Gerätemuster: **UP Profile light**
2. Hersteller: **UP International Sportartikel GmbH**

II. Nachgewiesene Normen und Verfahren: **EN 12491 / LTF 35/03**

III. Merkmale und Betriebsgrenzen

1. Gerätegewicht (ohne Außencontainer, kg): **1,6**
2. Max. zulässiges Gewicht (kg): **90**
3. Empfohlenes Gewicht (kg): **90**
4. Mittelleinen Schirm: **ja**
5. Sonstige Besonderheiten: **-**

IV. Betriebsanweisung in der Fassung vom: **November 2007**

V: Packnachweisheft in der Fassung vom: **November 2007**

Ort, Datum, Stempel und Unterschrift des Herstellers:

Garmisch, den 27.11.2007



UP International GmbH
Kreuzschuhweg, 7
82407 Garmisch-Partenkirchen
Germany
Phone: +49-8921-7399-0
Fax: +49-8921-7399-16
www.up-paragliders.com
info@up-paragliders.com

Sichtvermerk Prüfstelle:

Service booklet

Rescue system and pilot data

Model: **Profile light**

Size: ☐ 24

Serial number: _____

Colour: _____

Date of purchase: _____

First flight date: _____

Dealer stamp and signature

Pilot (1. owner)

Name: _____

Family name: _____

Street: _____

Town: _____

Postal code: _____

Country: _____

Telephone: _____

Fax: _____

Email: _____

Pilot (2. owner)

Name: _____

Family name: _____

Street: _____

Town: _____

Postal code: _____

Country: _____

Telephone: _____

Fax: _____

Email: _____

Pilot (3. owner)

Name: _____

Family name: _____

Street: _____

Town: _____

Postal code: _____

Country: _____

Telephone: _____

Fax: _____

Email: _____

Please verify that your UP Service Centre has correctly filled in the form!

1st Service

Performed date: _____

Service jobs undertaken:

Assignment Nr.
Stamp

2nd Service

Performed date: _____

Service jobs undertaken:

Assignment Nr.
Stamp

3rd Service

Performed date: _____

Service jobs undertaken:

Assignment Nr.
Stamp

Please verify that your UP Service Centre has correctly filled in the form!

4th Service

Performed date: _____

Service jobs undertaken:

Assignment Nr.
Stamp

5th Service

Performed date: _____

Service jobs undertaken:

Assignment Nr.
Stamp

6th Service

Performed date: _____

Service jobs undertaken:

Assignment Nr.
Stamp

Emergency Parachute Logbook

[illegible]

Product registration card

Model: **Profile light**

Size: ☐ 24

Serial number: _____

Date of purchase: _____

Date of first use: _____

Preflowed by: _____

Owner

Name: _____

Family name: _____

Address: _____

Telephone: _____

Fax: _____

Email: _____

Dealer stamp and signature

Cut out this card and mail it to UP within 14 days of purchase, or register your new UP Profile light via www.up-paragliders.com>Service>UP>Product Registration

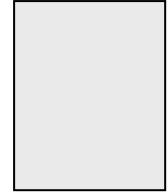

Ultralite Products
International GmbH
Kreuzeckbahnstrasse 7
82467 Garmisch-Partenkirchen
GERMANY

